

Mastercam X⁶

Enhancements

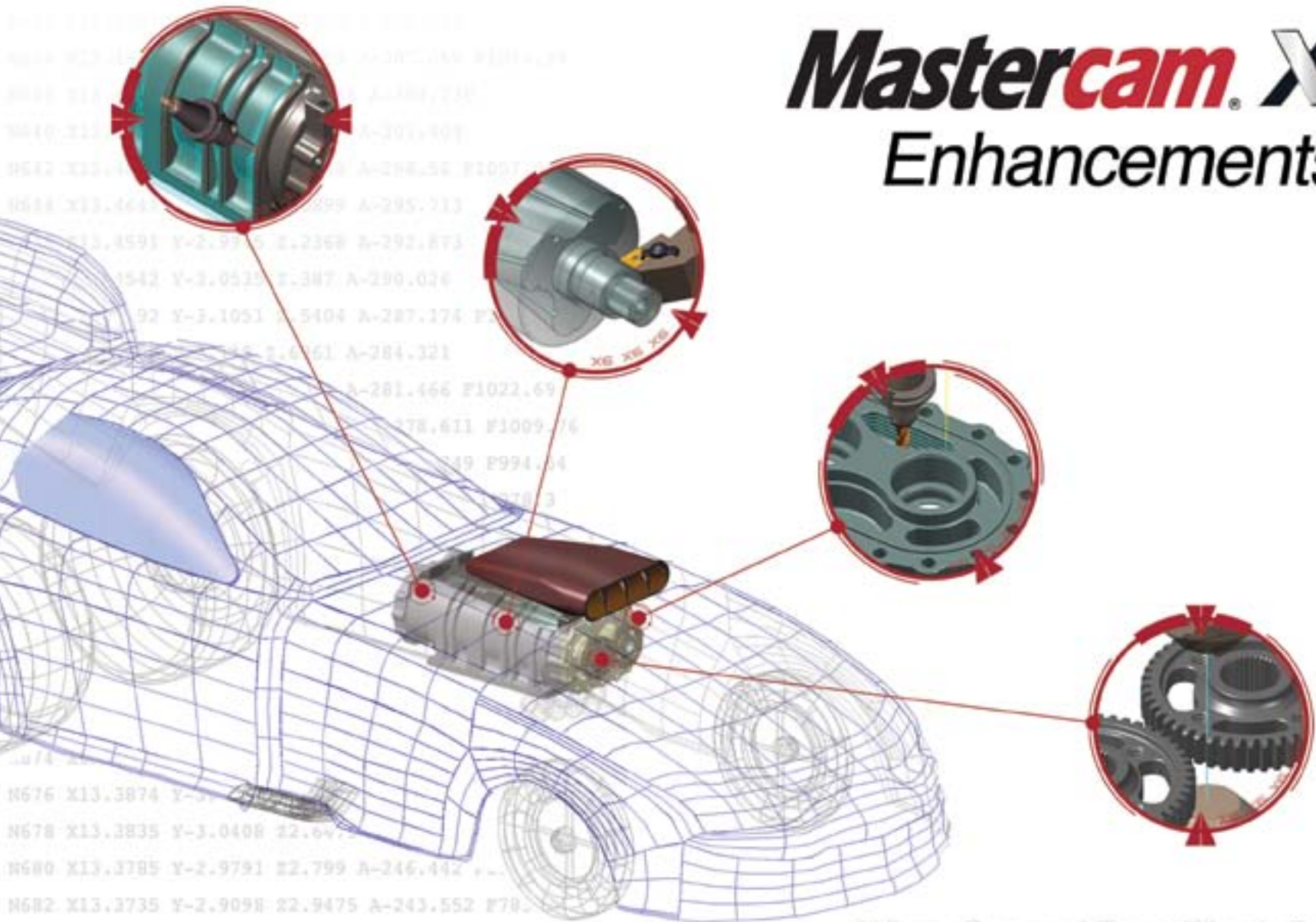

When Second Best Won't Cut It.

A preview of some powerful tools in Mastercam X6 . . .

Stock Model

A precise machining stock model delivers a variety of benefits—viewing and verifying work as it progresses, performing stock model comparisons, and easily choosing existing stock for rest machining. Mastercam gives you the power to create accurate, fully-associative stock models at any point in your machining process. You can reference the model within that project or save it as geometry for other uses. You can even quickly bring in outside CAD models to use as starting stock models for added flexibility.

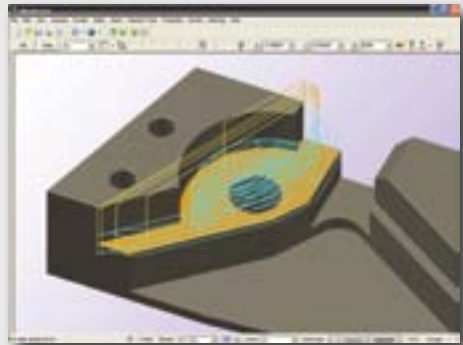

New region chaining simplifies 2D HST programming.

New 2D HST Region Chaining

Mastercam's 2D dynamic milling is now easier to use than ever with the introduction of Region Chaining. You can now explicitly define the area for a 2D dynamic milling toolpath by simply selecting the face to be machined and face (including non-planer faces) to be avoided. Mastercam treats the selections (even on open pockets) as complete machining chains.

2D HST Dynamic Toolpath Improvements

The 2D HST dynamic toolpaths include several enhancements. Variable toolpath radius allows the toolpaths to automatically adjust the toolpath radius in narrow channels or between islands. With outside approach control, the toolpaths now include the ability to specify which side of the stock the tool approaches from.

64-bit Support

Mastercam is now available as a 64-bit application, which lets you take full advantage of your 64-bit hardware and operating systems.

New OptiRest Toolpath

Mastercam's latest 3D High Speed toolpath performs Rest Milling operations to remove remaining material with optimized roughing motion. This powerful new toolpath can use the new stock model functionality for defining stock removal areas.

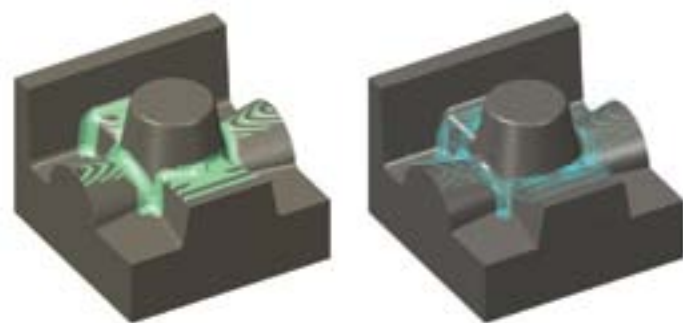

OptiRest can use Mastercam's in-process stock model to create an efficient rest roughing toolpath.

Blade Expert Add-on

Mastercam Blade Expert greatly simplifies the toolpath creation process for any multi-bladed parts, including fans, propellers, impellers, turbines, marine screws, and more. There is no limit to the number of blades, splitters, or sub-splitters that can be programmed. A few highlights include a variety of powerful and flexible multi-axis roughing strategies; precise cut pattern control on blade, fillet, and floor finishing; automatic tool axis control, ensuring smooth machine motion; and full machine simulation to aid in getting the most out of the machine. Blade Expert eliminates guess work, gives you smooth toolpaths, and dramatically reduces programming time.

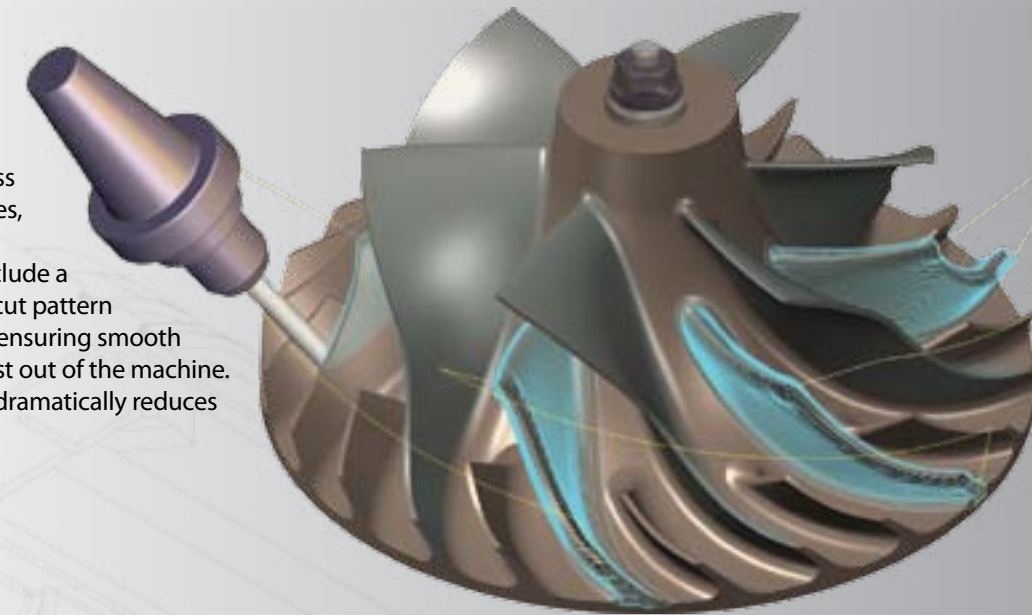

Mastercam Blade Expert simplifies toolpath creation for any multi-bladed parts.



Hybrid Filler Passes combines waterline and scallop toolpath motion.

3D HST Hybrid Finish Filler Passes

3D High Speed Hybrid toolpaths now maintain all of the Z level cuts in the steep areas of your parts while filling in the shallow areas with scallop motion within a single Z section. These toolpaths combine the best of both worlds with waterline (constant Z) motion and scallop where needed. Now you can have both waterline and scallop motion at the same Z section, section after section. The result is a much better finish and more efficient use of the tool.

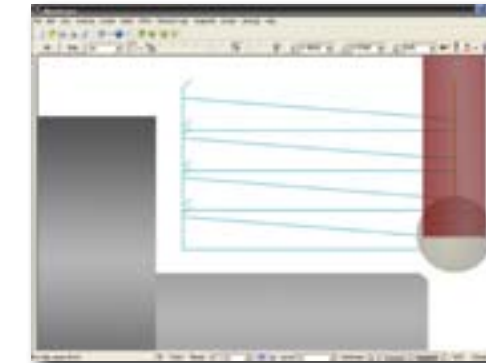

Mastercam's variable depth roughing results in a much longer insert life.

Lathe - Variable Depth Roughing

Ceramic turning inserts often experience "notching" — imperfections that quickly develop when a roughing pass repeatedly engages the material at the same point. Mastercam's variable depth roughing solves this. The tool moves in at an angle on the first roughing pass, so the material contact point moves. Then the tool takes the second pass in a horizontal cut, using the now angled stock to maintain variable contact. The result is a much longer insert life. To see a more detailed list of other Lathe enhancements, please visit www.mastercamlathe.com.

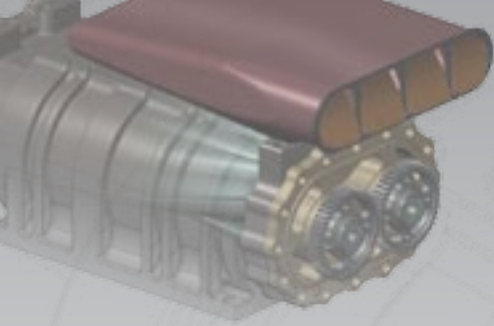

A few more highlights of what's new in Mastercam X6:

- New 2D HST Region Chaining for easier chaining
- New OptiRest toolpath
- Stock Model creation and tracking
- Blade Expert add-on
- 64-Bit Support
- Xform fit nests parts along a vector
- Toolpath Menu reorganization
- New improved tool support
- 2D HST Dynamic Toolpath improvements
- 2D Contour smoothing
- 3D HST Hybrid Finish Filler Passes
- OptiRough strategy now offers OptiCore and OptiArea
- Port Expert add-on
- Canned Rough and Finish improvements
- Facing and Canned Groove Toolpaths
- Grooving Toolpath improvements
- Finish Tool inspection
- Rough Remaining Stock
- New AutoSync Rails
- Variable depth roughing for efficient turning with ceramics
- Wirepath Editor improvements
- File translator updates

**For more information about Mastercam X6, contact your
Mastercam reseller or visit www.mastercam.com/enhancements.**

Mastercam[®]
cnc software, inc.

671 Old Post Road Tolland, CT 06084 USA
(800) 228-2877 • (860) 875-5006 • Fax (860) 872-1565
www.mastercam.com • mcinfo@mastercam.com



Mastercam[®] and Mastercam University[™] are registered trademarks of CNC Software, Inc. ©Copyright 1983-2011.
All rights reserved. SolidWorks[®] is a registered trademark of DS SolidWorks Corporation. ISCAR is a registered
trademark of ISCAR, Ltd. All other trademarks are property of their respective owners.